



## PRODUCT DETAILS

# SYNERGY FUSION

SYNERGY FUSION is a flexible solution designed to give the user the ability to create different learning environments to suit their teaching style on the day. The unit can be used as a traditional display while the screen is raised and can also be retracted when it is not needed, providing clear line of sight for students.

SYNERGY is designed to provide users with a dynamic and interactive solution that is fully AV and IT integrated and meets the high standard expected from educational furniture today.

### Features

- Electronic retractable screen (42" - 50" screens)
- 2x 1U top loading internal rack space
- Removable panels for equipment access
- Wide range of worktop shapes and sizes
- Soft close lid for smooth open and close action
- Piezo anti collision system



### Collaboration is key

Creating active learning environments to enhance student collaboration.



### 2x 1U rack space

Allows rack mounted equipment to be integrated behind the screen and in the lower section of the unit.



### Facilitates seamless AV/IT integration

Complete internal cable management creates an 'all-in-one' solution.

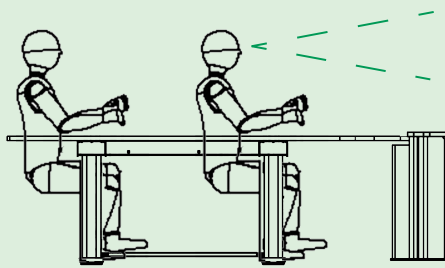

## All eyes on the lecturer

The screen can be retracted when it is not needed, providing clear line of sight for students.



## A shape for every requirement...

Our table shapes help promote discussion and enhance engagement.

- Please note, these are our recommended worktop shapes. We are happy to discuss other requirements.
- Recommended for use with a 50" screen.

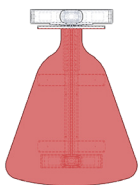

**Plectrum**  
6 seat

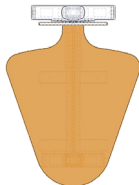

**Plectrum Reverse**  
3 & 5 seat

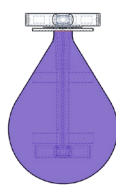

**Teardrop**  
6 seat



**Quad**  
4 & 6 seat



**Blade**  
4 & 6 seat



**Height Adjustable**  
5 & 7 seat



● Suitable for 42" - 50" screens

● All eyes on the lecturer  
Clear line of site to the teacher whilst maintaining access to IT without using fixed screens.



Standard connectivity:  
- Data interface plate: 1x 13A  
- Cable well: 3x HDMI / 1x MiniDP

Removable panels for easy equipment access

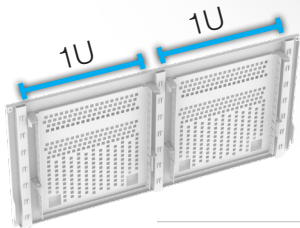
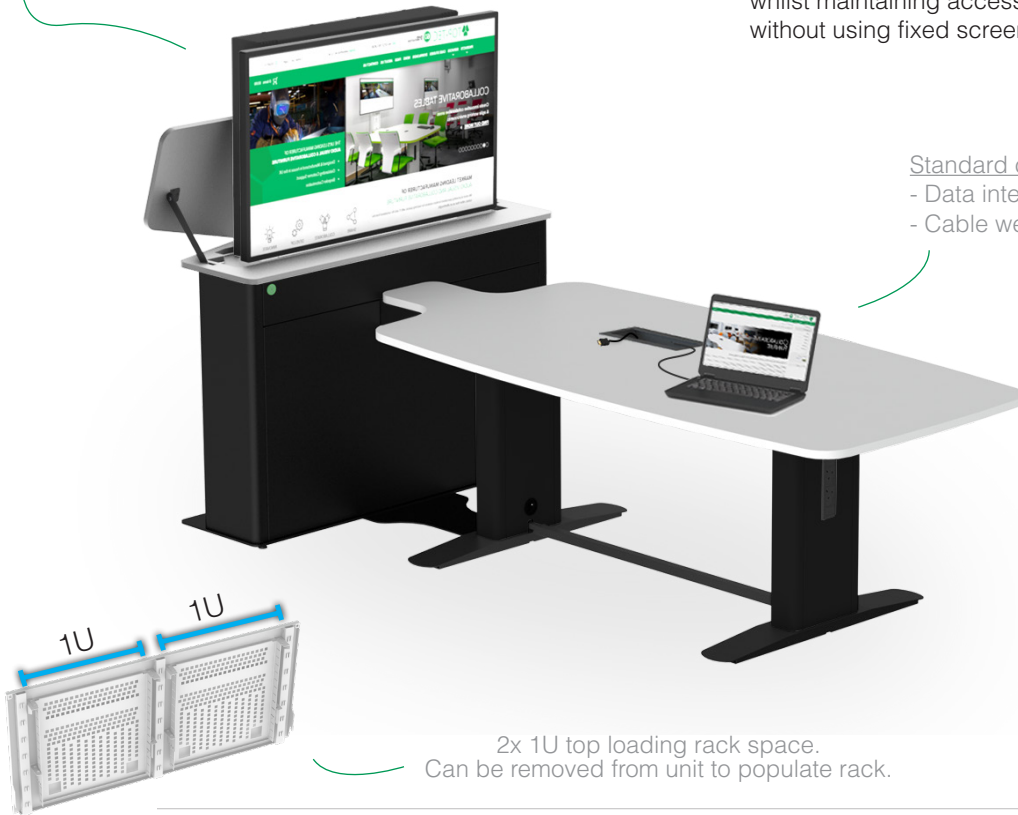

2x 1U top loading rack space.  
Can be removed from unit to populate rack.



## Technical Information

Model	Code	Screen information	MAX screen size
SYNERGY FUSION	FYQD06 (Quad 6-seat example)	42" - 50" up to 400x400 VESA	1175mm(W) x 65mm(D) x 650mm(H)

### Included

- Choice of standard paint, worktop & edge banding finishes
- Data interface plate: 1x 13A socket
- Cable well: 3x HDMI / 1x MiniDP
- 2x 13A socket in front leg

### Additional Cost

- Non-standard paint, worktop & edge banding finishes
- Bespoke connectivity (USB C / MiniDP / Lightning)
- PC cage
- Worktop power modules
- Worktop mounted control panel housing
- Extended neck
- Desktop machining
- 'Shark-nose' worktop edge
- Under desk rack storage (8U / 10U / 12U)

### Standard Paint Finishes



### Standard Worktop Finishes

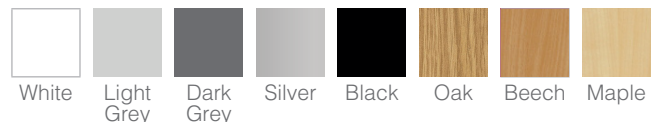

### Make it your own!

We offer a range of non-standard colours and finishes. Many custom colours can be supplied at standard pricing but may incur an additional cost.

For further information about our solutions and to discuss your individual requirements please contact a member of the TOP-TEC team.

TOP-TEC is a brand of Dalen Limited  
Valepits Road, Garretts Green, Birmingham, B33 0TD  
T: +44 (0)121 783 3838 E: sales@top-tec.co.uk  
W: top-tec.co.uk